

Viewport 1
Scale @ 1:500

Reproduced from the Ordnance Survey map with the permission of the Controller of the Highway's Statutory Office. Licence no. 10000125. Crown copyright reserved.

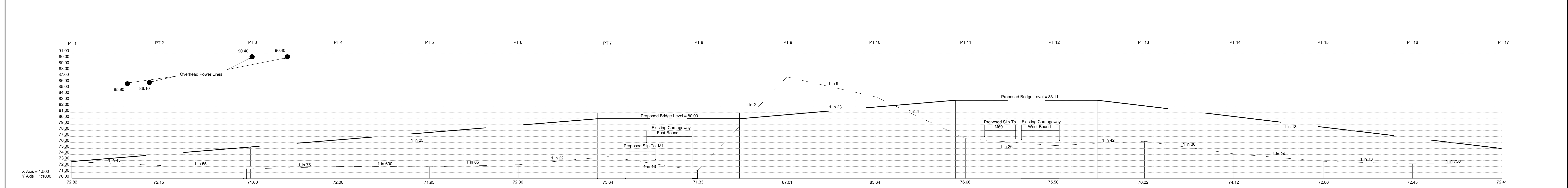

Viewport 2
Scale @ 1:250

Key:
 EXISTING GROUND LEVEL ———
 PROPOSED GROUND LEVEL - - - - -
 PROPOSED IMPROVEMENTS TO BE IMPLEMENTED BY THE HIGHWAYS AGENCY. ———

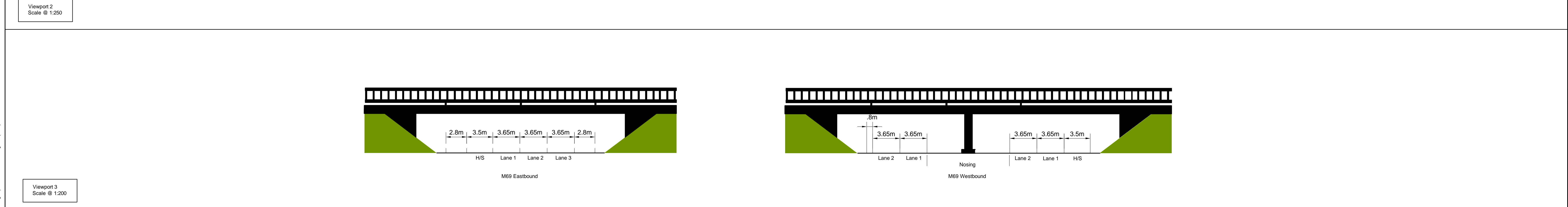

Viewport 3
Scale @ 1:200

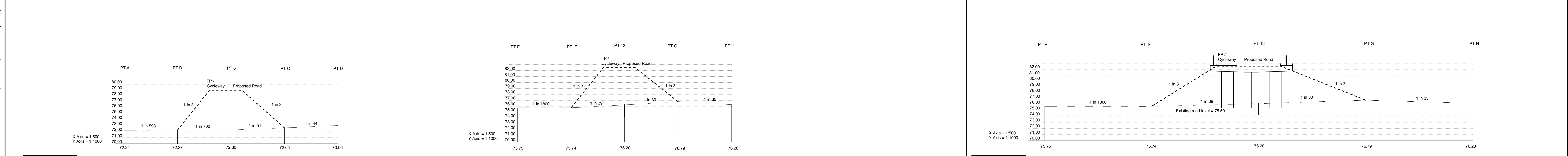

Viewport 4
Scale @ 1:250

Viewport 5
Cross Section A - A
Scale @ 1:250

REV	DATE	BY	CHK	APP	DESCRIPTION
1	02/03/12	JEV			FIRST ISSUE

Unit 9, The Chase, John Tale Road
 Foxholes Business Park, Herford SG13 7NN
 Tel: +44 (0)1992 529000 Fax: +44 (0)1992 529001
 http://www.wspgroup.com

CLIENT:	HLM, BARRATT HOMES & DAVIDSON DEVELOPMENTS
PROJECT:	FPCR
PROJECT:	LEICESTER, NEW LUBBESTHORPE
TITLE:	PROPOSED BRIDGES ACROSS M69 CROSS SECTION FIGURE 2.6.1.4
SCALE AS SHOWN	CHECKED: AH APPROVED: BP
DATE FILE: 1693-P-02	DESIGN-DOWN: EY DATE: February 2012
PROJECT NO: 11501693	DRAWING NO: 1693-P-02 REV: A