

Viewport 1  
Scale @ 1:500

Based upon the Ordnance Survey's (1:2500) Map of (insert year) with permission of the Controller of Her Majesty's Stationery Office. Crown copyright reserved. Waterman Boreham Ltd, Regent House, Hubert Road, Brentwood, Essex, CM14 4JE. License No. 100170822.  
This drawing is based upon topographical survey information supplied by Green Hatch Group. Waterman Boreham shall not be liable for any inaccuracies or omissions.

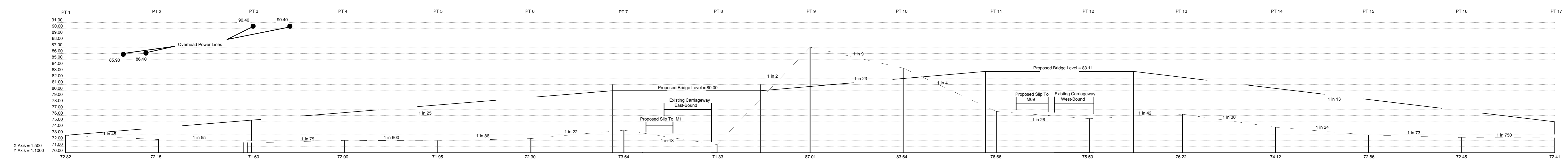

Viewport 2  
Scale @ 1:250

Key,  
Existing ground level ———  
Proposed ground level - - - - -  
Proposed improvements to be implemented by the Highways Agency. ———

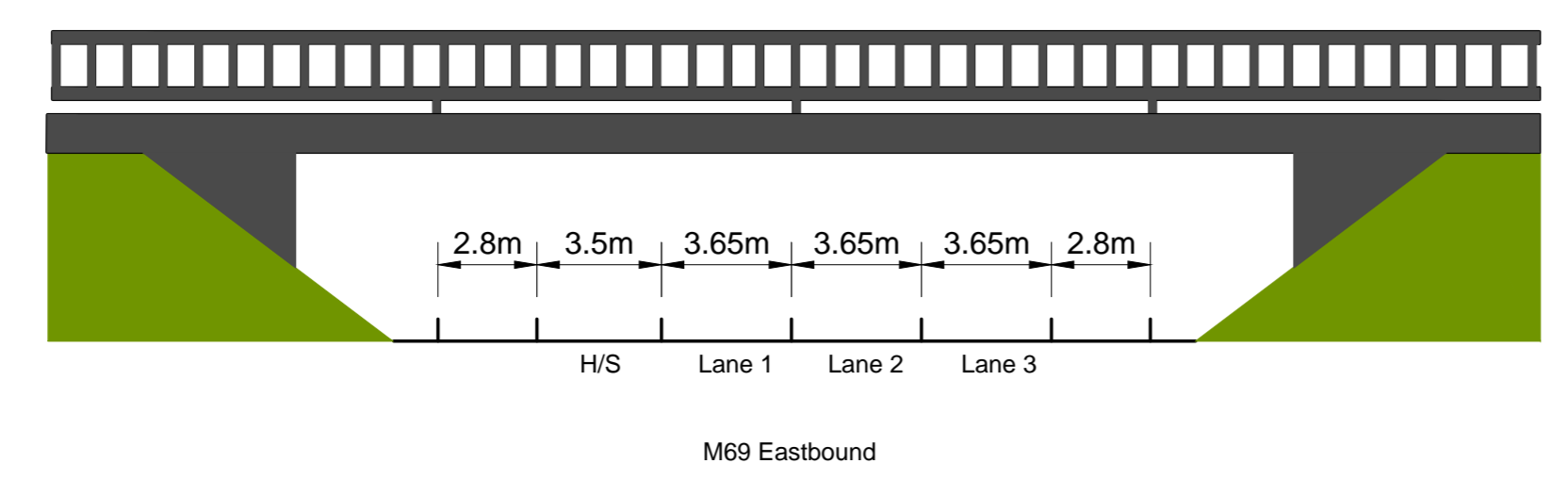

M69 Eastbound

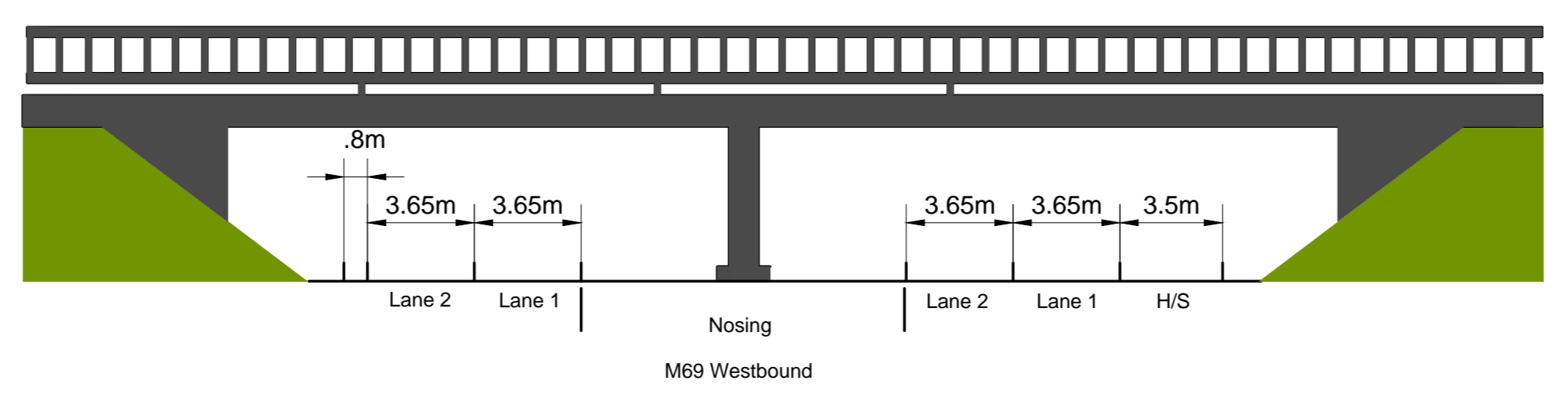

M69 Westbound

Viewport 3  
Scale @ 1:200

Rev	Date	Description	By
B	06/10/10	Road widths amended.	JH
A	22/03/10	Motorway cross sections added.	JH

Project  
**P.U.A Leicester**  
Title  
**Proposed Bridges Across M69 Cross Section.**

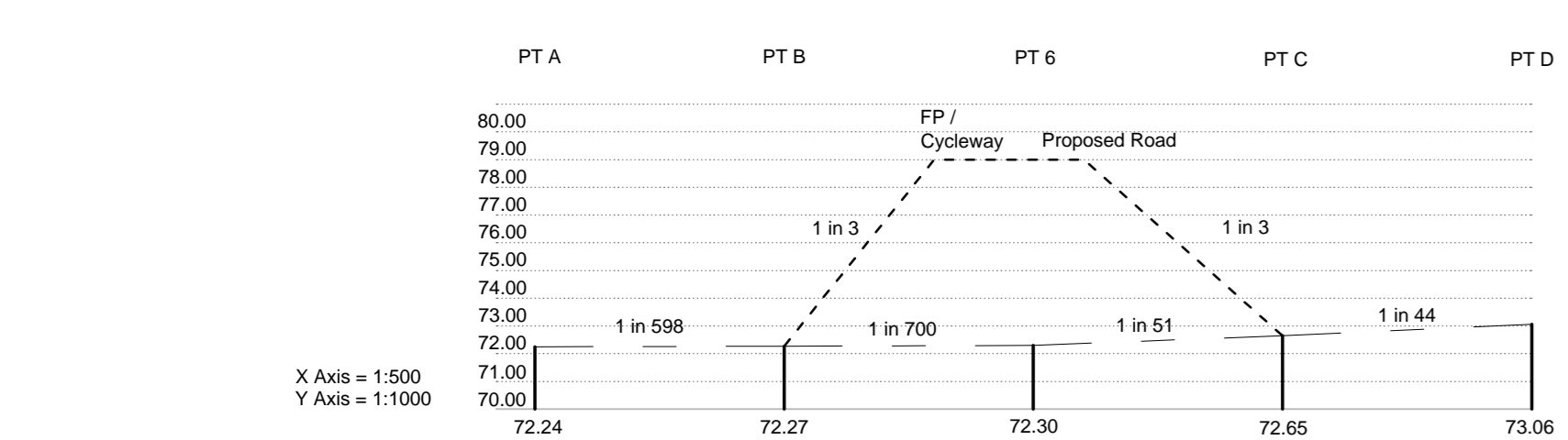

Viewport 4  
Scale @ 1:250

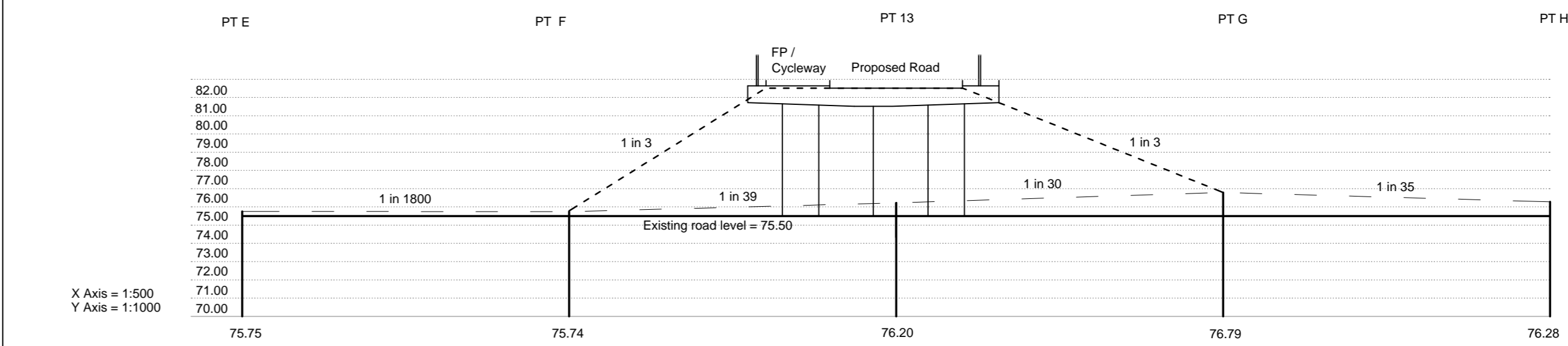
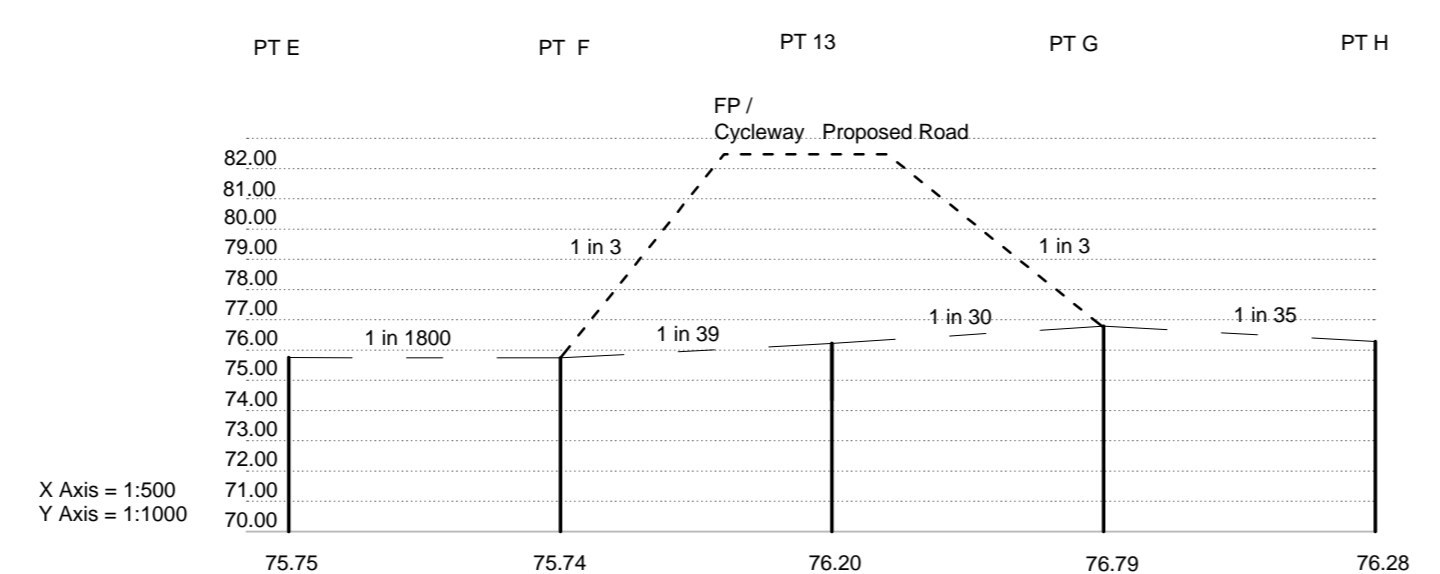

Viewport 5  
Cross Section A - A  
Scale @ 1:250

Client  
HLM, Barratt David Wilson and Davidson Developments.

**Waterman Boreham**  
Transport Planning

Regent House, Hubert Road, Brentwood, Essex, CM14 4JE  
101277 236 100 | 01277 236 100  
enquiries@waterman-boreham.com | www.waterman-boreham.com

Drawing Date: **FINAL**

Designed by	JH	Checked by	BP	Project No.	208133
Drawn by	JH	Date	03.02.11	Scale @ A2	As Shown
Author	TRN	Zone	---	Category	---
Number	2.6.4	Revision	B		